

Type	WB	AB	GL	DB	C	c_{min}	D	d	a	b	e	f	g	h	i	k	l
WG 70						79	70	25	110	130	23	10	40	60	80	44	8.5
WG 75					75		25										
WG 85					85		30										
WG 90					90		35	130	157	26	14	52	79	94	50	8.5	
WG 95					95		40										
WG 110					110		50										
WG 115					115		50	160	190	30	14	70	100	115	65	12.5	
WG 130					130	60											
WG 150					150	75											

Gummierung.....

Geschwindigkeit $V =$ m/min

Temperatur $T =$ °C

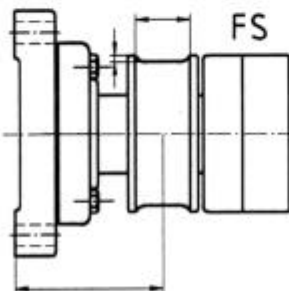

frei laufende
Seilscheibe

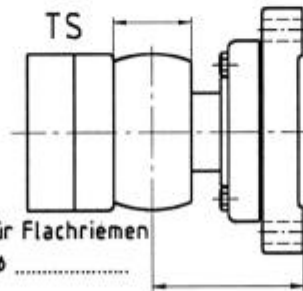

ballig für Flachriemen
Außen ϕ

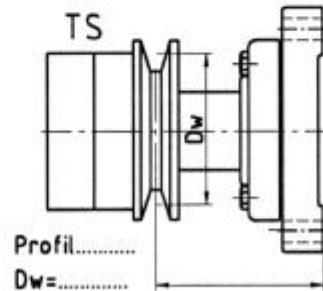

Profil.....
Dw=.....

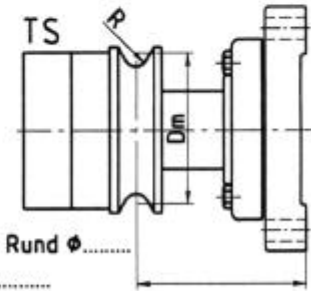

Profil Rund ϕ
Dm=.....

Breitstreckwalze
mit Gummimantel
"Trockenbetrieb"

Zeich.Nr.

03/001

Angebot./Kom.Nr.

KICKERT

Westring 29
D-33818 Leopoldshöhe
Tel.05202-98280
Fax05202-982828
www.kickert.de